

Angular Contact Ball Bearings

Brass cage angular contact ball bearing-7320 BECBY

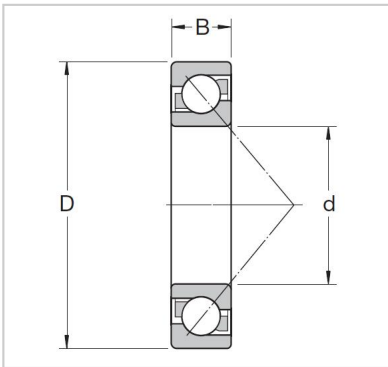

Abutment and fillet dimensions

Db max.	7320 BECBY
Da max.	7320 BEP
da min.	100
rb max.	215
ra max.	47

Dimensions

a	203
r3,4 min.	190
r1,2 min	6.4
D1	3 600
d2	3 600
d1	7.5

Mass

KG	144
----	-----

Speed ratings r/min

Limiting speed	120
Reference speed	174

Fatigue load limit

Pu kN	3
-------	----------

Basic load ratings KN

dynamic C kN	1.1
static Co kN	90

Basic design bearing

B mm	114
D mm	201
d mm	208

Basic design bearing

	2.5
--	-----

Designations

Universally matchable bearing	1
-------------------------------	---